

PINTLES FASTENED TO THE RUDDER
WITH 5 x 50 mm STAINLESS STEEL
SCREWS

GUDGEONS FASTENED
TO THE TRANSOM WITH
M5 STAINLESS STEEL BOLTS

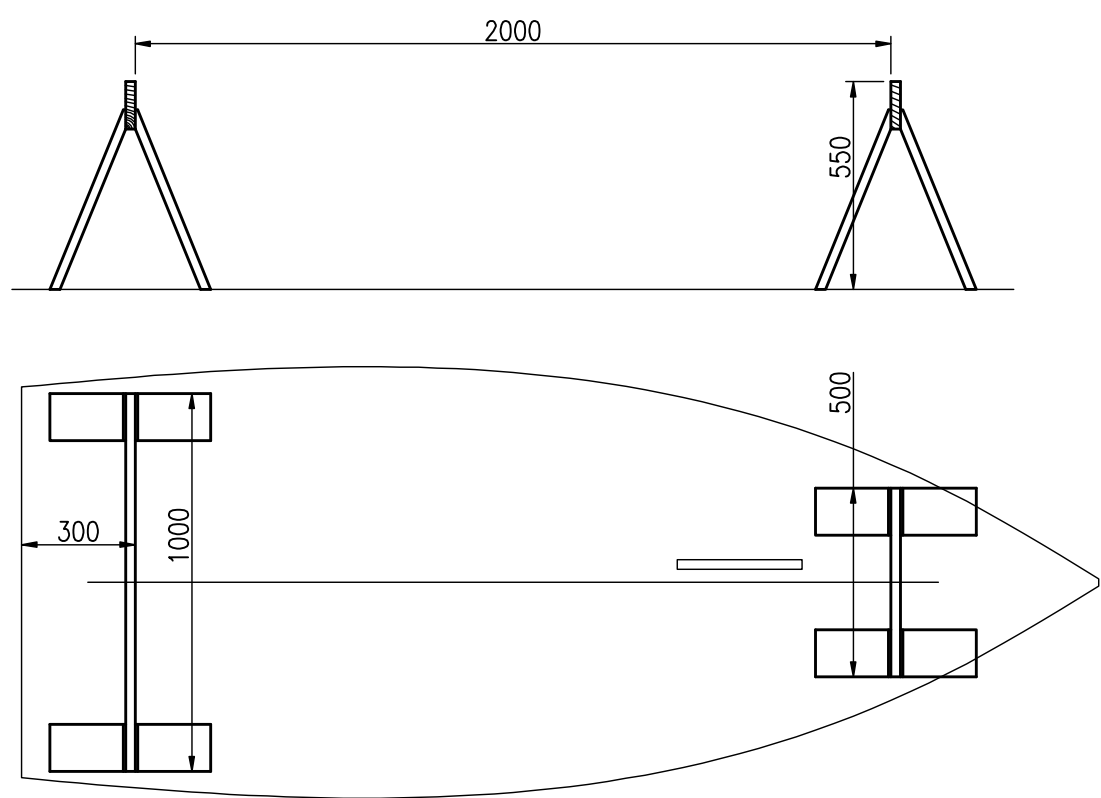

SCREWED OF LUMBER OR 22 mm PARTICLEBOARD
RESAWN INTO 125 mm WIDE PANELS

BOTTOM SET UP ON THE BUILDING STOCK
AND POSITIONED TO THE AFT EDGE, THEN
TEMPORARILY FASTENED WITH TWO SCREWS
TO EACH TRESTLE BEAM

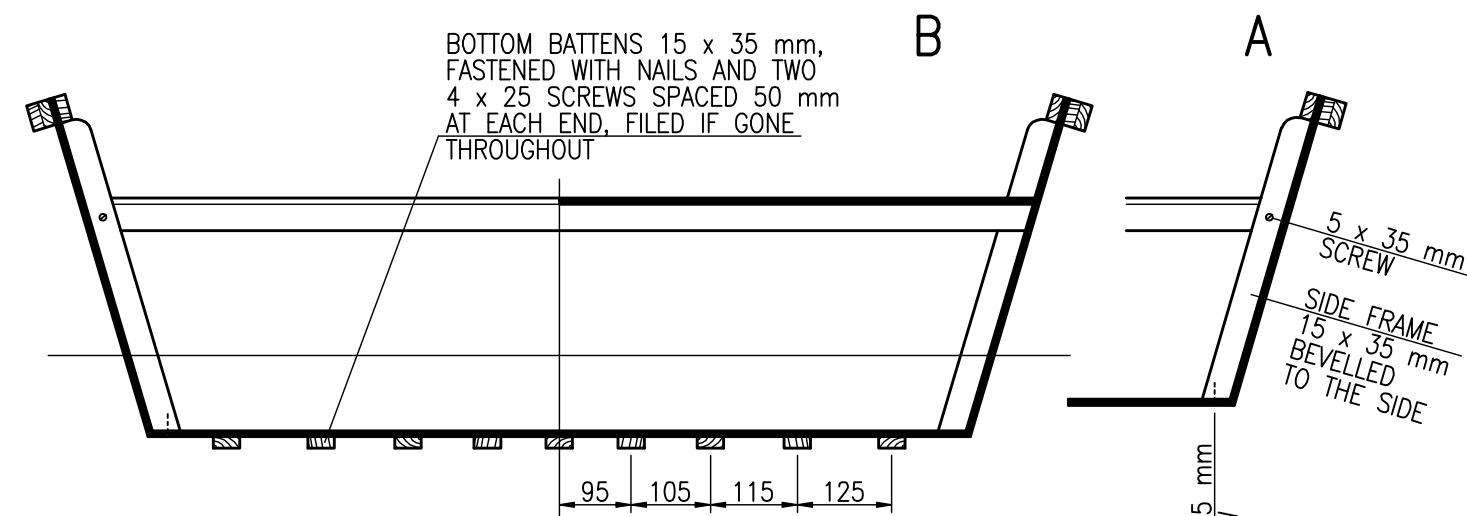
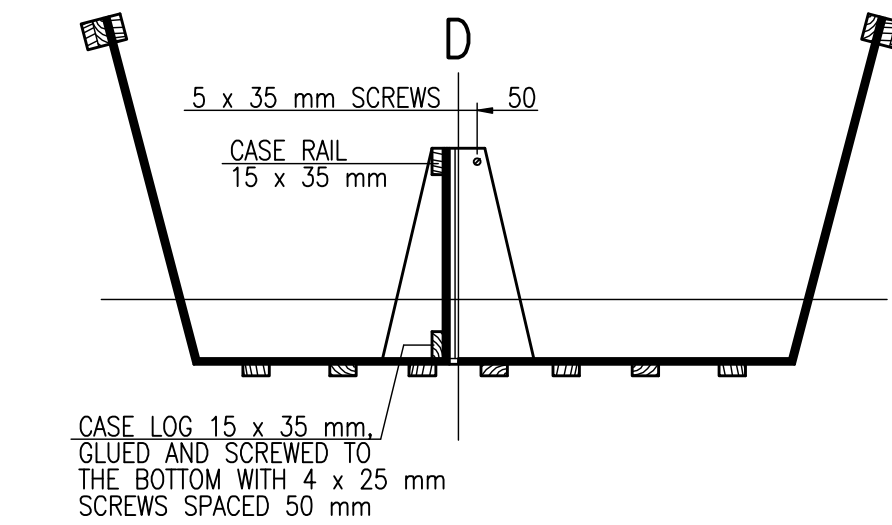
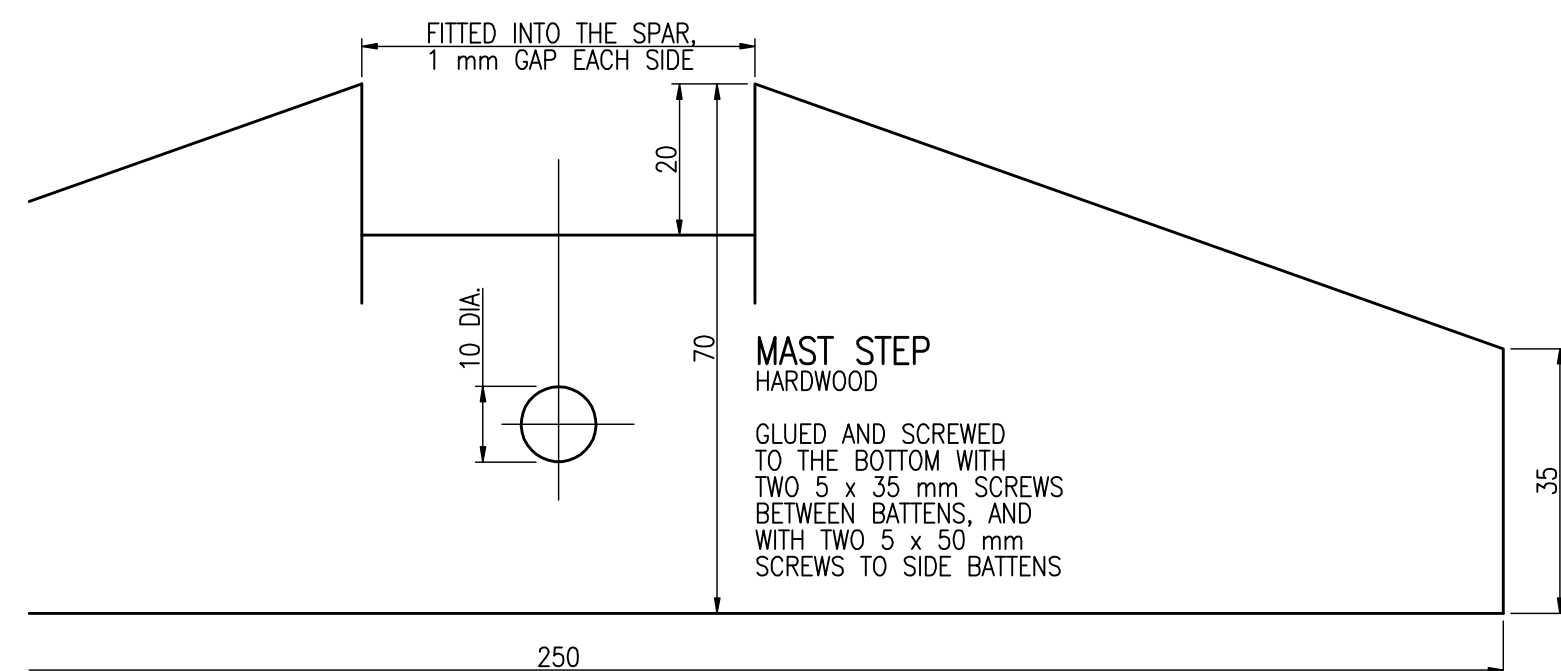

L_{OA}	3.00 m
L_{WL}	2.85 m
B	1.40 m
B_{WL}	1.20 m
T_C	0.10 m
T	0.55 m
F_A	0.350 m
F_F	0.475 m
∇	0.21 m ³

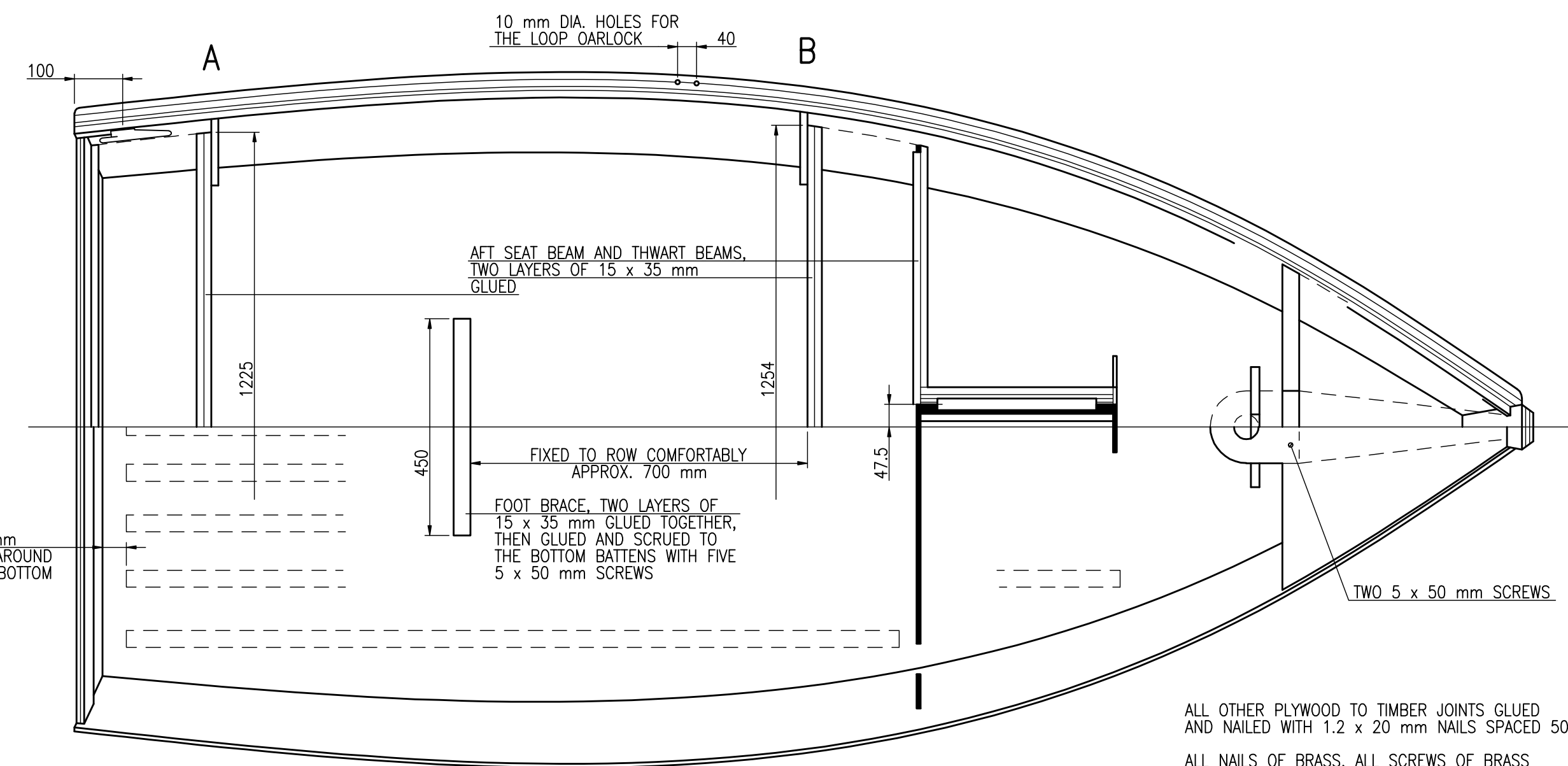

ALL PLYWOOD TO PLYWOOD JOINTS WITHOUT TIMBER
FIRST STITCHED WITH 1-1.5 mm COPPER WIRE, THEN
TAPED BOTH SIDES WITH EPOXY OR POLYESTER RESIN
AND ONE LAYER OF CHOPPED STRAND MAT EACH SIDE.
MAT WEIGHT 450 g/m². MAT STRIPS WIDTH 100 mm

AFT SEAT AND THWART TAPED TO SIDES UNDERSIDE ONLY



OAR BLADE, 8 mm PLYWOOD,
GLUED AND SCREWED TO THE SHAFT
WITH SIX 4 x 25 mm SCREWS

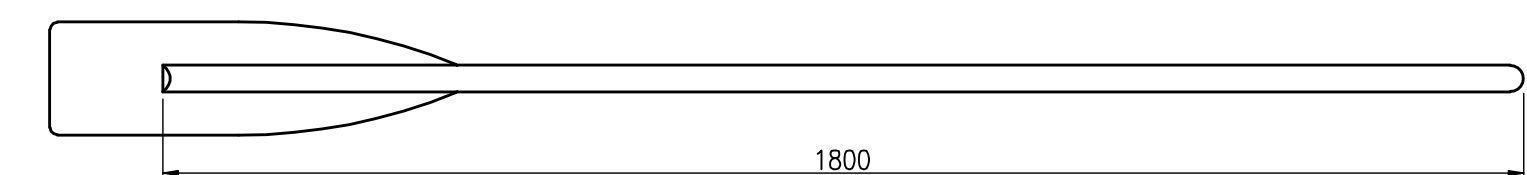

3.0m

HULL CONSTRUCTION, OARS
SHEET 30.3/5, SIZE A1
SCALE 1:1, 1:5, 1:10, 1:20

RADOSŁAW WERSZKO
AUGUST 2012, AUGUST 2013